

POLY 2180

VD (1"3/8 M-M)

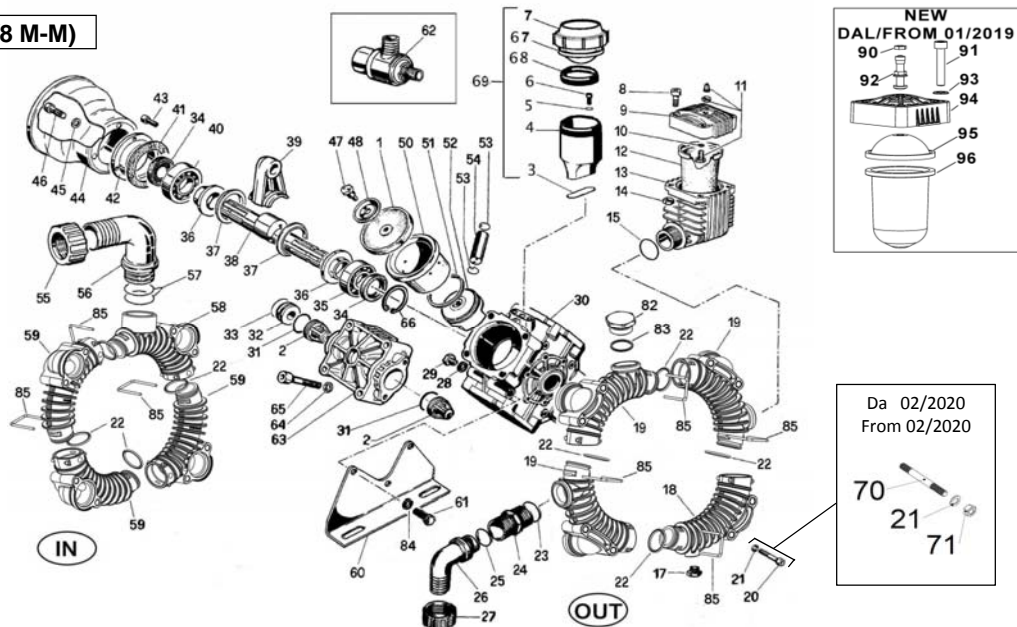

VERSIONI

VC (1"3/8 - D.1" M-F)
VC (1"3/8 - D.25mm M-F)

VS (1"3/8 M)

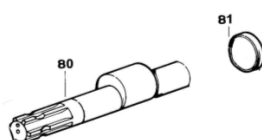
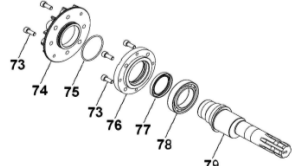

POS.	CODICE PART NO. REF.	DENOMINAZIONE - DESCRIPTION - DESCRIPTION	Q.TY	POS.	CODICE PART NO. REF.	DENOMINAZIONE - DESCRIPTION - DESCRIPTION	Q.TY
1	62.0040.00.ADS	PRESET DURAMAX PISTON DIAPHRAGM (STD)	4	43	86.2562.20.2	SCREW M8x20 UNI5931	4
1	62.0040.00.A	PRE-SET DESMOPAN PISTON DIAPHRAGM (OPT)	4	44	31.1482.32.2	PLAIN SAFETY CONE L=180 (OPTIONAL)	1
1	62.0040.33.2	VITON PISTON DIAPHRAGM (OPT)	4	44	31.1468.32.2	PLAIN SAFETY CONE L=135 (OPTIONAL)	1
1	62.0040.36.2	HPS PISTON DIAPHRAGM (OPT)	4	45	84.3710.00.2	WASHER DIA.8,5x24x2	4
2	28.9905.97.3	S.S. AISI 316 VALVE ASSY (STD)	8	46	86.2682.50.2	SCREW M8x25 UNI5931	4
2	28.9809.97.3	S.S. AISI 303 VALVE ASSY (OPT)	8	48	62.9811.97.3	KIT SCREW/DISK INOX	4
2	63.9800.97.3	POLYPROPYLENE VALVE ASSY (OPT)	8	50	62.0019.01.2	PISTON SLEEVE	4
3	80.3209.00.2	O-RING 2,62x39,34	1	51	81.8540.00.2	PISTON RING DIA.78	4
4	14.0117.32.2	BOWL OIL FILLER	1	52	62.0018.09.2	PISTON DIA.78	4
5	84.3585.00.2	WASHER D.6,4x12,5x1,6	2	53	80.0021.00.2	RING DIA.15	8
6	86.2168.00.2	SCREW M6x22 UNI5931	2	54	85.2006.70.2	PISTON PIN DIA.15	4
7	28.0144.32.2	OIL FILLER CAP	1	55	82.0120.00.2	WING NUT G.2"	1
8	86.2752.50.2	SCREW M8x35 UNI5931	4	56	84.0596.00.2	90° ELBOW CONNECTOR DIA.45-1,77"	1
9	11.0004.09.2	BALLASTER COVER (BEFORE 01-19)	1	56	84.1642.80.2	STRAIGHT CONNECTOR D.45-1,77" (OPT)	1
10	80.3213.00.2	O-RING 3,0x6 (BEFORE 01-19)	1	56	84.1643.00.2	STRAIGHT CONNECTOR D.50-1,96 (OPT)	1
11	86.1608.50.2	AIR VALVE (BEFORE 01-19)	1	56	84.0610.00.2	90° ELBOW CONNECTOR DIA.50-1,96 (OPT)	1
12	23.0041.31.2	BALLASTER DIAPHRAGM (BEFORE 01-19)	1	57	80.3209.10.2	O-RING 2,62x40,95	2
12	23.0041.33.2	VITON BALLASTER DIA. (OPT) (BEFORE 01-19)	1	58	28.0158.32.2	MANIFOLD PIPE G.2"	1
12	23.0041.36.2	HPS BALLASTER DIA. (OPT) (BEFORE 01-19)	1	59	28.0156.32.2	INLET-OUTLET MANIFOLD PIPE	3
13	27.0035.32.2	DAMPER BODY	1	60	28.0021.61.2	MOUNTING RAIL	2
14	81.4573.50.2	NUT M8 UNI5588	4	61	86.3276.05.2	SCREW M10x30 UNI5931	6
15	80.3219.10.2	O-RING 3x30	1	62	24.3016.97.3	SAFETY VALVE 15bar (OPTIONAL)	1
17	85.2577.10.2	CAP G.3/8 +OR	1	63	62.0025.32.2	HEAD	4
18	28.0159.32.2	MANIFOLD PIPE WITH HOLE G.3/8	1	64	84.3845.00.2	WASHER DIA.12,2x21x2,5	16
19	28.0157.32.2	MANIFOLD PIPE G.1"	3	65	86.4068.50.2	SCREW M12x75 UNI5931	16
20	86.2951.05.2	SCREW M8x65 UNI5931 (BEFORE 02/2020)	16	66	80.1369.00.2	RING DIA.52	1
21	84.3685.40.2	WASHER DIA.8,2x15x1,5	16	67	41.0017.31.2	DIAPHRAGM OIL FILLER	1
22	80.3255.00.2	O-RING 3,53x36,10	8	68	14.0116.32.2	SPACER	1
23	80.3219.10.2	O-RING 3,0x30	1	69	14.9888.97.3	OIL FILLER KIT	1
24	83.5089.00.2	NIPPLES G.1"-G.1"1/4	1	70	83.8260.20.2	STUD M8 (FROM 02/2020)	16
25	80.3219.00.2	O-RING 3,0x25	1	71	81.4573.00.2	NUT M8 (FROM 02/2020)	16
26	84.0542.40.2	90° ELBOW CONNECTOR DIA.25-1"	1	73	86.2588.10.2	SCREW TCEI M8x20	8
26	84.0560.00.2	90° ELBOW CONNECTOR DIA.30-1,18" (OPT)	1	74	31.1725.07.2	COVER	1
26	84.0565.00.2	90° ELBOW PIPE FITTING DIA.32-1,25" (OPT)	1	75	80.3210.20.2	O-RING DIA.2,62x60	1
27	82.0067.50.2	WING NUT G.1"1/4	1	76	31.1724.46.2	CENTRAL COVER	1
28	82.4066.00.2	GASKET	1	77	80.2191.10.2	OIL SEAL DIA. 45x62x7	1
29	86.3694.65.2	CAP M12	1	78	81.2946.00.2	BEARING 50x80x16	1
30	28.0003.09.2	CRANKCASE	1	79	62.0108.26.2	HOLLOW SHAFT VC D.1"	1
31	80.3314.00.2	O-RING 4,5x40	8	79	62.0108.26.2A	HOLLOW SHAFT VC D.25mm	1
32	28.0229.32.2	VALVE ASSY SPACER	4	80	62.0010.26.2	SHAFT "VS"	1
33	80.3209.40.2	O-RING 2,62x44,12	4	81	80.2099.60.2	CAP 52x7	1
34	80.2143.10.2	OIL SEAL DIA.35x52x7	2	82	85.2720.00.2	CAP G.1	1
35	81.2846.00.2	BEARING DIA.35x72x17	1	83	80.3206.00.2	O-RING 2,62x28,25	1
36	28.0027.09.2	SHAFT SPACER (VD)	2	84	84.3760.00.2	SCHNORR WASHER 10,5x16x1	6
36	28.0027.09.2	SHAFT SPACER (VS-VC)	1	85	25.0217.51.2	FORK Ø4 - INT. 40	8
37	98.0047.76.2	CONNECTING ROD RING	2	90	86.1611.00.2	AIR VALVE NUT (FROM 01-19)	1
38	62.0024.26.2	CRANKSHAFT "VD"	1	91	86.2852.00.2	SCREW M8x45 (FROM 01-19)	4
39	28.0033.11.2	CONROD	4	92	86.1609.00.2	AIR VALVE (FROM 01-19)	1
40	81.2867.00.2	BEARING DIA.35x80x21	1	93	84.3685.40.2	WASHER D.8,4x15x1,5 (FROM 01-19)	4
41	98.0110.72.2	GASKET	1	94	11.0183.32.2	BALLASTER COVER (FROM 01-19)	1
42	98.0108.09.2	COVER	1	95	10.0041.31.2	SUP. BALLASTER DIAPHRAGM (FROM 01-19)	1
				96	23.0094.31.2	INF.BALLASTER DIAPHRAGM (FROM 01-19)	1